

Buy-a-Brick Program Memorial Landscape

We are designing for 2200 pavers to be custom engraved and professionally inlaid into prominent spaces in our site plan. Our primary design will be near the west entrance with potential to increase our memorial space at the east entrance.

- 4 X 8 Brick Cost is \$150.00
- 8 X 8 Brick Cost is \$350.00
- Bench Cost is \$3,000
- You can have up to 3 lines with a 4 X 8 Brick or 6 lines with a 8 X 8 brick, each line may have up to 14 characters.
- All letters are Uppercase only and you can use the ampersand symbol. (&)
- Bench will have an engraved plaque.

Bricks can be purchased in Memory Of, In Honor Of, as a Dedication or In Recognition of a family member, children, grandchildren or even a business.

To purchase a brick, fill out the order form on the back of this sheet and return it to the parish by **March 25th, 2018**. Please indicate clearly on the form what you would like etched on each brick. Memorial pavers are in addition to the recognition planned for all donors to the Opening Doors Campaign

For more information on the Buy-a-Brick Program visit www.stpatsgh.org or call Mellan Hansen at the parish office: 616-842-0001 extension 120.

Pastor
Fr. Chuck Schwartz

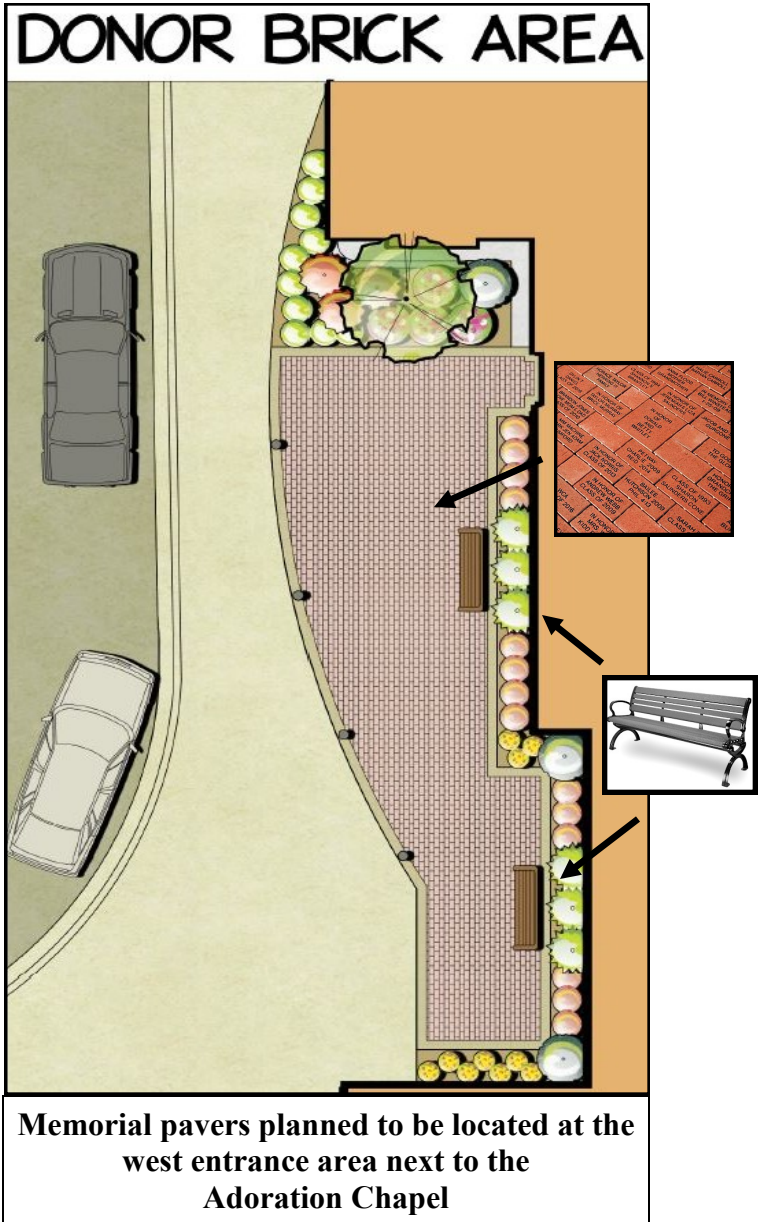

COMMEMORATIVE BRICK ORDER FORM

PURCHASER INFORMATION

NAME: _____

ADDRESS: _____

CITY: _____ STATE: _____ ZIP: _____

PHONE: _____

4 X 8 BRICKS: _____ **X \$150 = TOTAL \$** _____

8 X 8 BRICKS: _____ **X \$350 = TOTAL \$** _____

• **MEMORIAL BENCH:** _____ **\$3,000 TOTAL \$** _____

• (Office will contact for bench plaque engraving)

ARE THESE BRICKS TO BE PLACED TOGETHER? YES _____ NO _____ *BRICKS ARE PLACED RANDOMLY.

PLEASE USE ADDITIONAL FORM IF MORE BRICKS ARE NEEDED.

4 X 8 BRICK #1 PRINTING ON BRICK (ONE CHARACTER PER BLOCK, INCLUDING SPACES, UP TO 3 LINES):

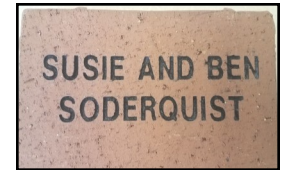

4 X 8 BRICK #2 PRINTING ON BRICK (ONE CHARACTER PER BLOCK, INCLUDING SPACES, UP TO 3 LINES):



8 X 8 BRICK PRINTING ON BRICK (ONE CHARACTER PER BLOCK, INCLUDING SPACES, UP TO 6 LINES):



RETURN THIS FORM ALONG WITH CASH OR CHECK TO THE PARISH OFFICE.