

# Buy-a-Brick Program Memorial Landscape

We are designing for 2200 pavers to be custom engraved and professionally in-laid into prominent spaces in our site plan. Our primary design will be near the west entrance with potential to increase our memorial space at the east entrance.

- 4 X 8 Brick Cost is \$150.00
- 8 X 8 Brick Cost is \$350.00
- Bench Cost is \$3,000
- You can have up to 3 lines with a 4 X 8 Brick or 6 lines with a 8 X 8 brick, each line may have up to 14 characters.
- All letters are Uppercase only and you can use the ampersand symbol. (&)
- Bench will have an engraved plaque.
- To order a bench please call the Parish office

## DONOR BRICK AREA

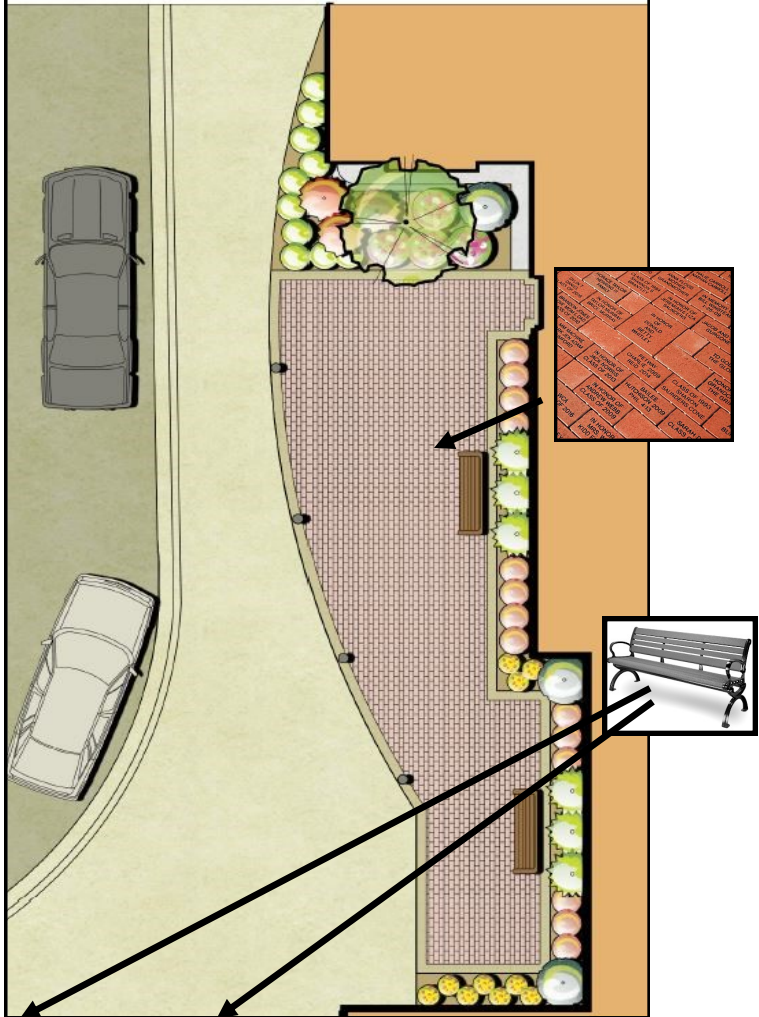

**Bricks or Benches can be purchased in Memory Of, In Honor Of, as a Dedication or In Recognition of a family member, children, grandchildren**

Memorial pavers planned to be located at the west entrance area next to the Adoration Chapel

To purchase a brick, fill out the order form on the back of this sheet and return it to the parish by **July 31, 2018** Please indicate clearly on the form what you would like etched on each brick. Memorial pavers are in addition to the recognition planned for all donors to the Opening Doors Campaign

For more information on the Buy-a-Brick Program visit [www.stpatsgh.org](http://www.stpatsgh.org) or call Mellan Hansen at the parish office: 616-842-0001 extension 120.

Pastor  
Fr. Chuck Schwartz

# COMMEMORATIVE BRICK ORDER FORM

**PURCHASER INFORMATION**

NAME: \_\_\_\_\_

ADDRESS: \_\_\_\_\_

CITY: \_\_\_\_\_ STATE: \_\_\_\_\_ ZIP: \_\_\_\_\_

PHONE: \_\_\_\_\_

# 4 X 8 BRICKS: \_\_\_\_\_ X \$150 = TOTAL \$ \_\_\_\_\_

# 8 X 8 BRICKS: \_\_\_\_\_ X \$350 = TOTAL \$ \_\_\_\_\_

• MEMORIAL BENCH: \_\_\_\_\_ \$3,000 TOTAL \$ \_\_\_\_\_

• (Office will contact for bench plaque engraving)

ARE THESE BRICKS TO BE PLACED TOGETHER? YES \_\_\_\_\_ NO \_\_\_\_\_ \*BRICKS ARE PLACED RANDOMLY.  
PLEASE USE ADDITIONAL FORM IF MORE BRICKS ARE NEEDED.

**4 X 8 BRICK #1 PRINTING ON BRICK (ONE CHARACTER PER BLOCK, INCLUDING SPACES, UP TO 3 LINES):**

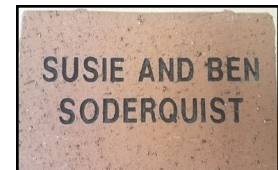
**4 X 8 BRICK #2 PRINTING ON BRICK (ONE CHARACTER PER BLOCK, INCLUDING SPACES, UP TO 3 LINES):**



**8 X 8 BRICK PRINTING ON BRICK (ONE CHARACTER PER BLOCK, INCLUDING SPACES, UP TO 6 LINES):**



RETURN THIS FORM ALONG WITH CASH OR CHECK TO THE PARISH OFFICE.